

# Sehab Executive Tower – Seef District



Best for Business

## **Twin towers of 19 offices each in prime location**

One office per floor - Office Total Area: 224 sq/m - Each office includes washrooms, kitchen, balcony and lift lobby – Half floor option available - Parking ratio 1 per 35 sq/m – Business Lounge available – Offering panoramic views of the Arabian Gulf, Seef District and Manama City

BD7 – 9 per sq/m  
Subject to 15% Service Charge

For more information and viewings please contact:

**Tel: +973 17212000**

**info@century21.bh**

**www.century21.bh**

# Sehab Executive Tower – Seef District

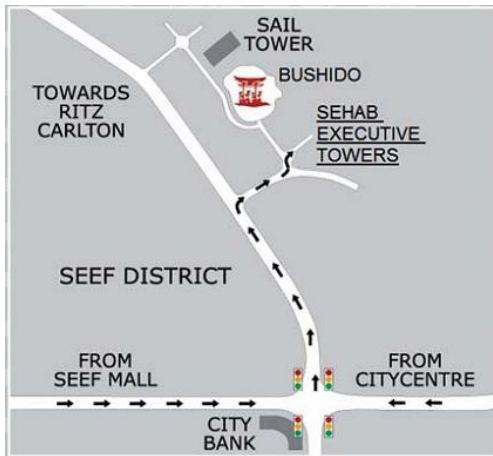

## Location

- Strategically situated in prime location within the Seef District which is fast developing as a main business hub in Bahrain
- Offers ease of access with convenient road links to Saudi Arabia, Manama City Centre and Bahrain International Airport

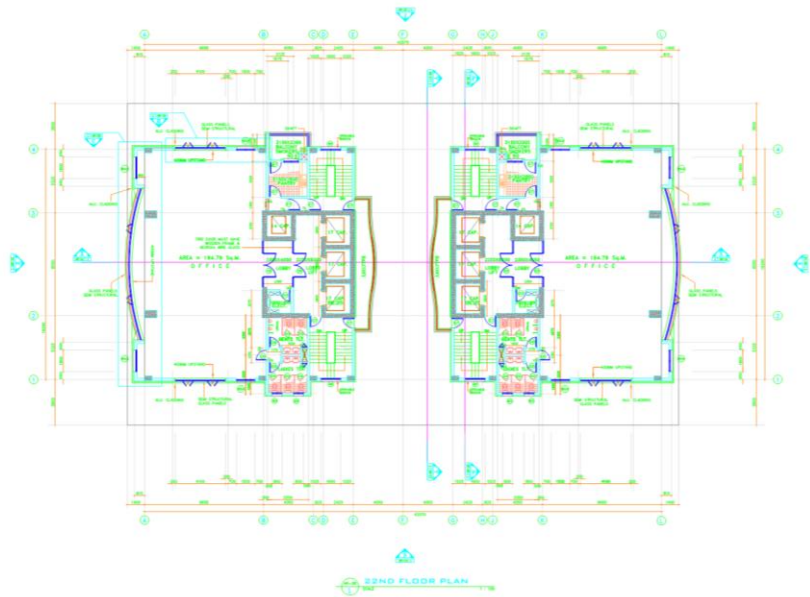

## Benefits

- 3 months grace period for fit out
- Special corporate rates at The Ritz-Carlton Bahrain Hotel & Spa for the 1st year.
- Discount of 15% on all meals (excluding beverages) for the 1st year at the Ritz-Carlton Hotel, Bushido Restaurant and Trader Vics Restaurant.
- Special discounted offsite catering rates provided by The Ritz-Carlton Hotel & Spa.
- Complimentary welcome hamper provided by The Ritz-Carlton Hotel & Spa
- Option to purchase The Ritz-Carlton Sports Club Membership
- Enrollment in the ERS Appreciation Awards Program at The Ritz-Carlton Hotel & Spa

## Specifications

- One office per floor with half floor option
- Shell condition with fit out option.
- 19 Offices in each tower with a total of 38 Offices
- Each floor is approximately 224 sq/m with balcony, pantries and washrooms fitted
- Stylish reception area
- 3 High speed elevators
- Mezzanine level offering lounge with business centre and cafeteria

## Parking

- 72 Indoor parking spaces located on the first 4 floors of the building,
- 74 shaded spaces at the ground floor level as well as 100 dedicated spaces outside the premises.

For more information and viewings please contact:

**Tel: +973 17212000**

**info@century21.bh**

**www.century21.bh**